



Tappex[®] - Electric Screwdrivers & Power Supplies

for self-cutting threaded inserts

TAPPEX® ELECTRIC SCREWDRIVERS AND POWER SUPPLIES

For self-cutting threaded inserts

TAPPEX® ELECTRIC SCREWDRIVERS AND POWER SUPPLIES

The installation equipment of the series 035/E for self-cutting threaded inserts includes five types of electric screwdrivers, two power supplies and a balance arm which fulfill in combination the installation demands of all self-cutting threaded inserts within the TAPPEX® range.

With the integrated 1/4 inch hex holder of the electric screwdrivers, the usability of TAPPEX® production drivers of the series 029/E is for the installation and combination still guaranteed.

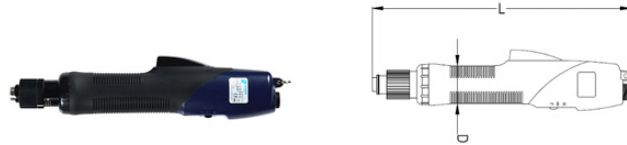

ELECTRIC SCREWDRIVER 32V | BN 2114

Screwdriver	Part number	Torque range	Speed	Voltage	L mm	D mm
1	035/E/A0.3-32V	0,29 – 1,86 Nm	700 / 1.000 U/min.	32V	245,00	36,50
2	035/E/A1.0-32V	0,98 – 2,94 Nm	900 / 1.200 U/min.	32V	285,00	39,90



ELECTRIC SCREWDRIVER 40V | BN 2114

Screwdriver	Part number	Torque range	Speed	Voltage	L mm	D mm
3	035/E/A2.0-40V	2,00 – 6,00 Nm	750 / 1.000 U/min.	40V	302,00	41,00
4	035/E/A4.0-40V	4,00 – 12,00 Nm	660 / 880 U/min.	40V	302,00	41,00
5	035/E/A8.0-40V	8,00 – 25,00 Nm	250 / 350 U/min.	40V	302,00	41,00

POWER SUPPLY WITH OPTIONAL PROGRAMMABLE COUNTING FUNCTION | [BN 56058](#)

Part number	Voltage
035/E/40V	40V
035/E/32V	32V



COMBINATION POSSIBILITIES OF SCREWDRIVERS AND POWER SUPPLIES

Electric screwdriver	Power supply 035/E/32V	Power supply 035/E/40V	Adapter lead (035/E/40-32V required *)
035/E/A0.3 - 32V	✓	✓	✓
035/E/A1.0 - 32V	✓	✓	✓
035/E/A2.0 - 40V		✓	
035/E/A4.0 - 40V		✓	
035/E/A8.0 - 40V		✓	

(*) When combining a 32V screwdriver with a 40V power supply, an adapter cable is required to connect the two devices. Please order this additionally under BN 56095 article number 9042062.

BALANCE ARM LINEAR QUICK LQ25 | [BN 37191](#)

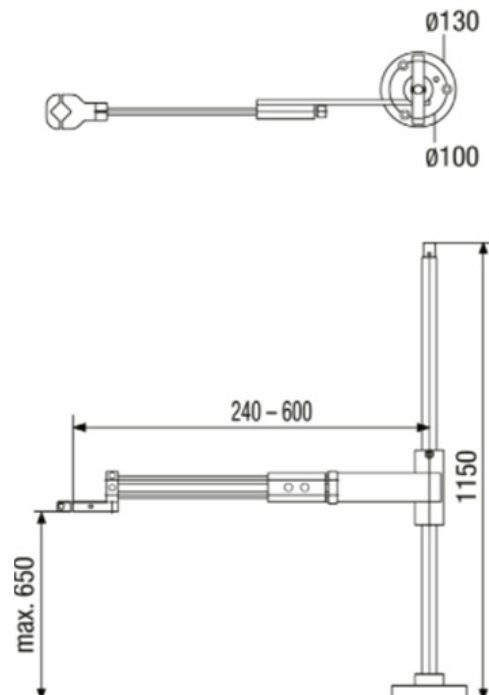

TAPPEX® PRODUCTION DRIVERS 029E | [BN 37829](#)

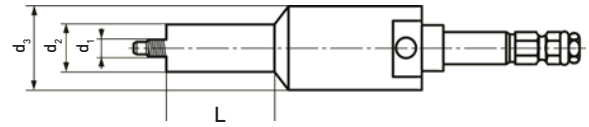

Part no.	d1	d ₃ mm	d ₂ mm	L mm
029E-M2-01	M2	19,00	7,00	16,00
029E-M2,5-01	M2,5	19,00	9,00	16,00
029E-M3-01	M3	19,00	9,00	16,00
029E-M3,5-01	M3,5	19,00	10,00	19,00
029E-M4-01	M4	19,00	11,00	25,00
029E-M5-01	M5	25,40	12,50	31,00
029E-M6-01	M6	25,40	16,00	38,00
029E-M8-01	M8	25,40	19,00	44,00
029E-M10-114	M10	25,40	25,40	60,00
029E-M12-113	M12	25,40	25,40	60,00

TAPPEX® PRODUCT SELECTION GUIDE OF ELECTRIC SCREWDRIVERS FOR THE SERIES TRISERT AND TRISERT-3

TAPPEX® Trisert and Trisert-3 threaded inserts Code	Size	Material				
		PP, ABS, HDPE	PA, POM, PC	PA 30% Glass fiber reinforced	Aluminum alloys (only Trisert-3)	
145- / 139-	M2	1				-
136- / 138-						
145- / 139- / 345- / 339-	M2,5	1				-
136- / 138- / 336- / 338-						
137- / 170-						
145- / 139- / 345- / 339-	M3	1	1 or 2		1 or 2	
136- / 138- / 336- / 338- / 6238-			1 or 2		2	
137- / 170- / 237- / 270- / 6270-	M3,5	1	1		-	
145- / 139- / 345- / 339-			1 or 2		1 or 2	
136- / 138- / 336- / 338-	M4	1 or 2				2
137- / 170-						2 or 3
145- / 139- / 345- / 339-						-
136- / 138- / 336- / 338- / 6238-	M5	1 or 2	1 or 2	2		4
137- / 170- / 237- / 270- / 6270-			2			
145- / 139- / 345- / 339-	M6	2	2		4	
136- / 138- / 336- / 338- / 6238-			2 or 3			
137- / 170- / 237- / 270- / 6270-			2 or 3			-
145- / 139- / 345- / 339-	M8	3		3		-
136- / 138- / 336- / 338- / 6238-		3				
237- / 270- / 6270-	M10	2 or 3	3	3 or 4		5
145- / 139- / 345- / 339- / 6239-		3 or 4	4			
136- / 138- / 336- / 338- / 6238-		4		4		
6270-	M12	4	4 or 5		5	
6239-			4 or 5			
6238-	M12	5				-
6270-						

Due to a wide variety of influencing factors, such as the exact material composition, mounting hole design, temperature influences, etc., the guidelines described in these data sheets are only intended as a guide. We assume no liability for the usability of the products described and recommend confirming the suitability and selection of the products described by prior testing of the required installation torque for the application. For technical inquiries, or for assistance with relevant audits and tests, please go to www.bossard.com

BOSSARD

Proven Productivity

www.bossard.com